

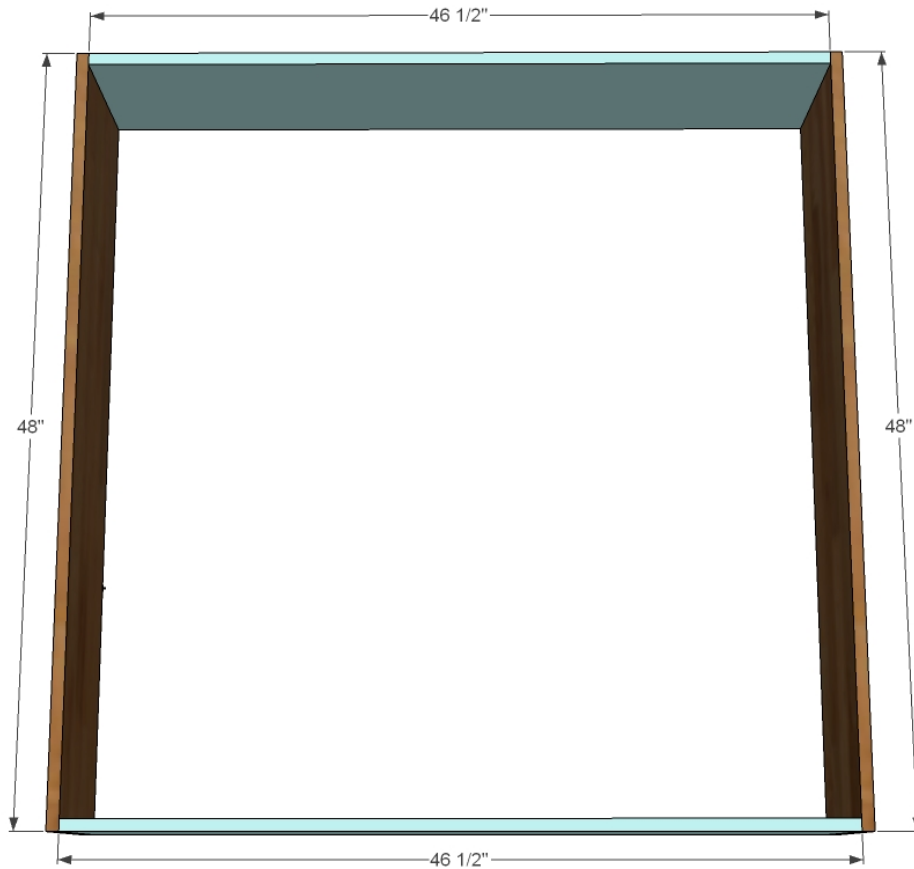

Shopping List	Cut List
4 - 1x12x8' boards (prefer MDF for paint) 2 - 1x2x8' boards (prefer MDF for paint) 4 - Leg Mounting Plates Screws for attaching mounting plates to bottom 4 - 12" Tapered Legs 1-1/2" staples Wood glue Wood filler Sandpaper Wall paper TOOLS Saw for cutting boards (prefer miter/chop saw) Airstrike stapler Drill for attaching table legs Power Sander Drill Bits, Driver Bits, Tape Measure, Pencil, Carpenter's Square	2 - 1x12 @ 48" 3 - 1x12 @ 46-1/2" 2 - 1x12 @ 29-3/4" 1 - 1x12 @ 16" 1 - 1/4" sheet MDF @ 48" x 48" 2 - 1x2 @ 45" 2 - 1x2 @ 48"

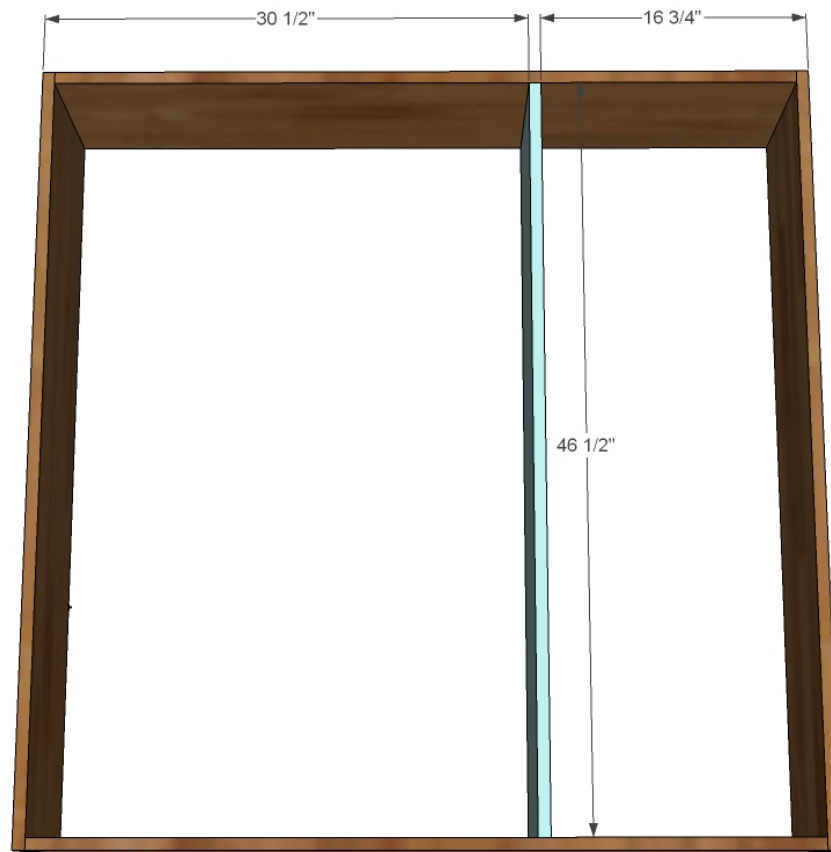

We'll start by building the basic shape of our bookshelf. Use glue and 1-1/2" staples to attach sides to top and bottom.



Three feet is about as long as a 1x12 shelf will go before it sags. Since our bookshelf is four feet wide, I added a vertical divider to make the shelf span less than three feet. I also like how it looks!

Mark the placement of the divider, and glue and staple to top and bottom.



Mark the placement for shelves, and attach with 1-1/2" staples and glue.

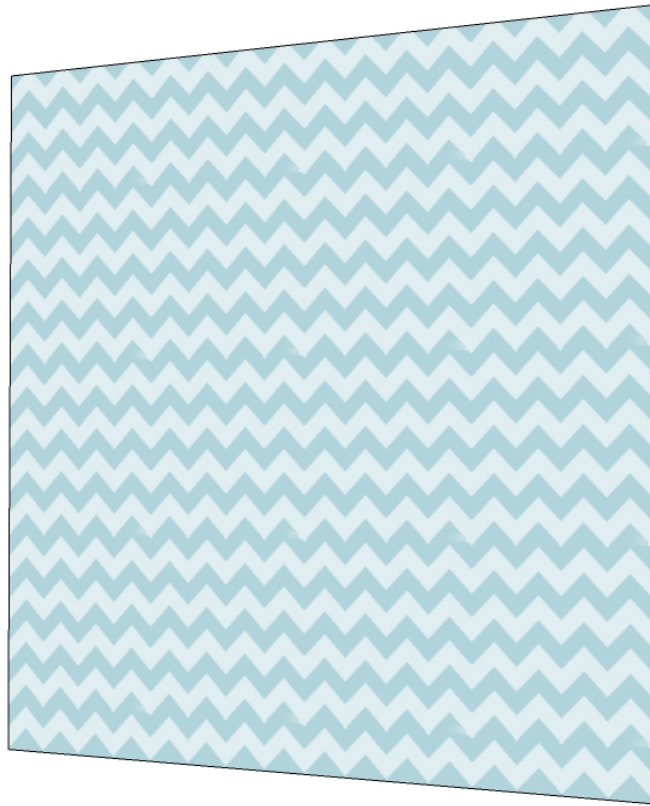

The back of the bookshelf is just a 1/2 sheet of 1/4" thick MDF - no cutting required! I choose MDF because it's smooth, and I am adding this fun wallpaper to the back. It's easy to do, just peel and stick!



I went ahead and painted the bookshelf pieces, so now I just attach the back with 1-1/2" staples and glue. I also attached the back to all of the shelves and vertical divider.

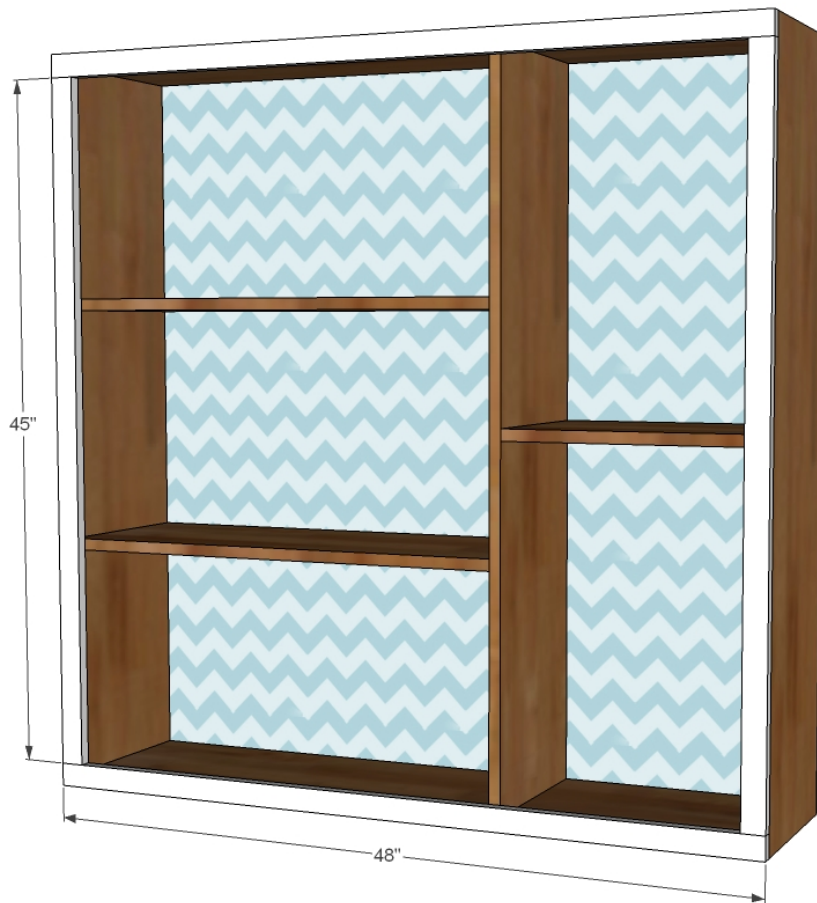

To give the bookshelf a little more strength, I decided to add a face frame made of 1x2s. 1x2s are stapled to the front of the bookshelf with glue. I also added a 1-1/2" staple to attach the 1x2s together at the corners.



To bring this bookshelf off the floor and add a little style to it, I decided to add legs! I found these legs at The Home Depot. I am using a dual mount plate, so you can either attach the legs straight or at an angle.

For this bookshelf, since it's tall and thin, the angled leg installation is a better choice because it helps prevent tipping.



The mounting plates are attached with screws to the bottom of the bookshelf. Then the legs just screw into the mounting plates.

Making a bookshelf is an easy project that anyone can do with a few tools! Now it's your turn!