

DIY Truck Bed Drawers

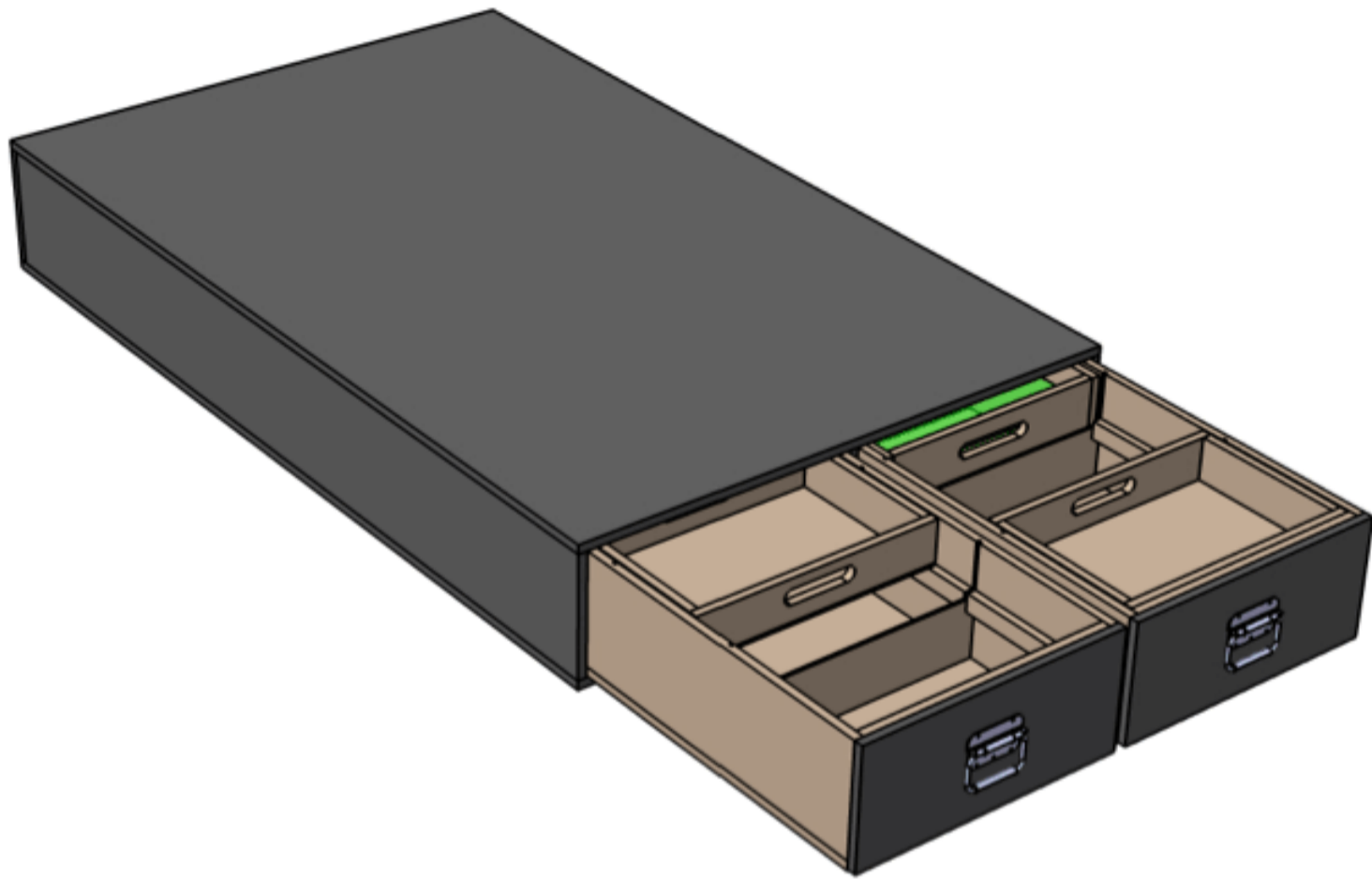

Required Tools

Table Saw
+Dado Blade (Optional)
Miter Saw
Drill/Driver
+Wood Drill Bits
Pocket Hole Jig
Jigsaw
Brad Nailer
Tape Measure
Sander

Materials

5x - 3/4" x 48" x 96" Plywood
1x - 1/4" x 48" x 96" Plywood
2x - 1 x 2 x 6' Common Boards
1-1/4" Wood Screws
1-1/4" Pocket Screws
1-1/4" 18g Brad Nails
Wood Glue
Drawer Pulls
Truck Bed Liner Paint
Stain or Paint as desired

Cut List (1 of 2)

3/4" x 48" x 96" (Qty 3)

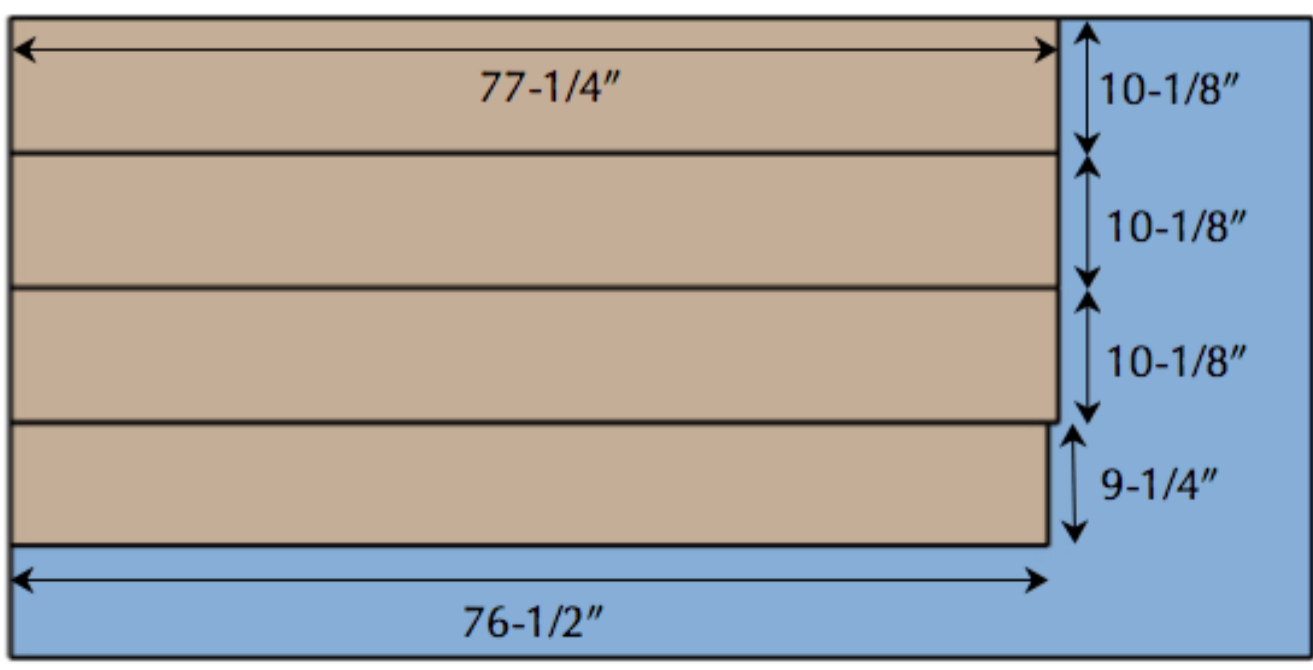
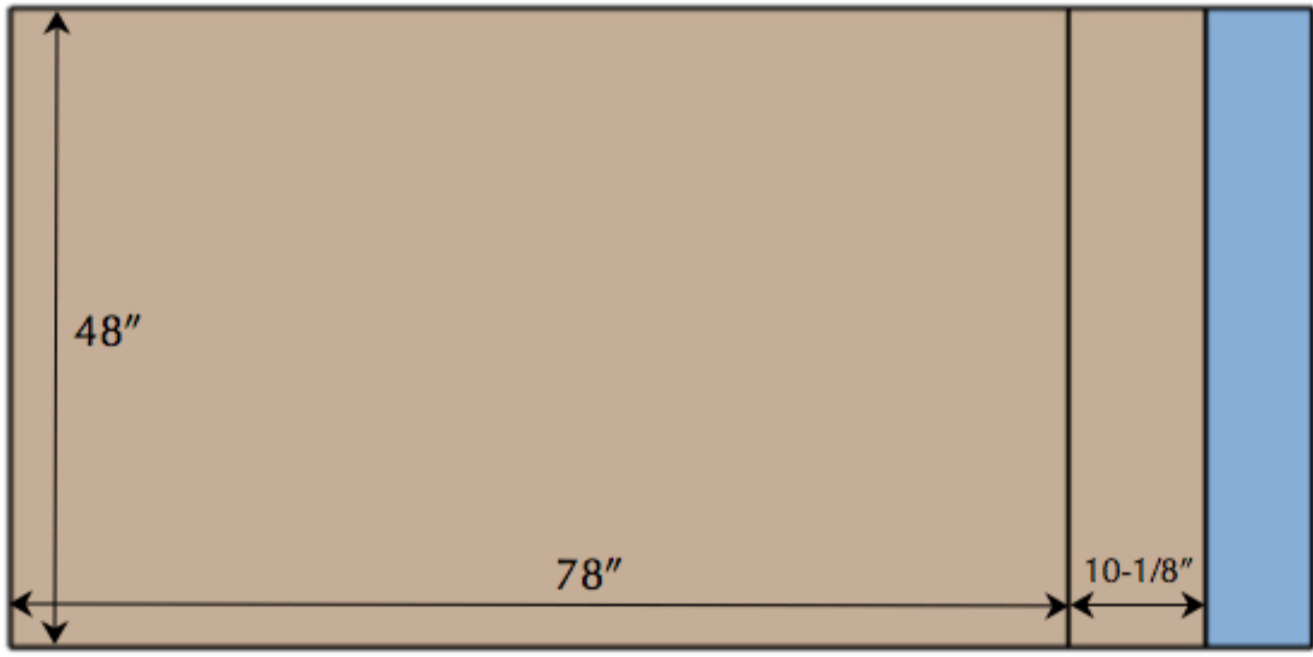
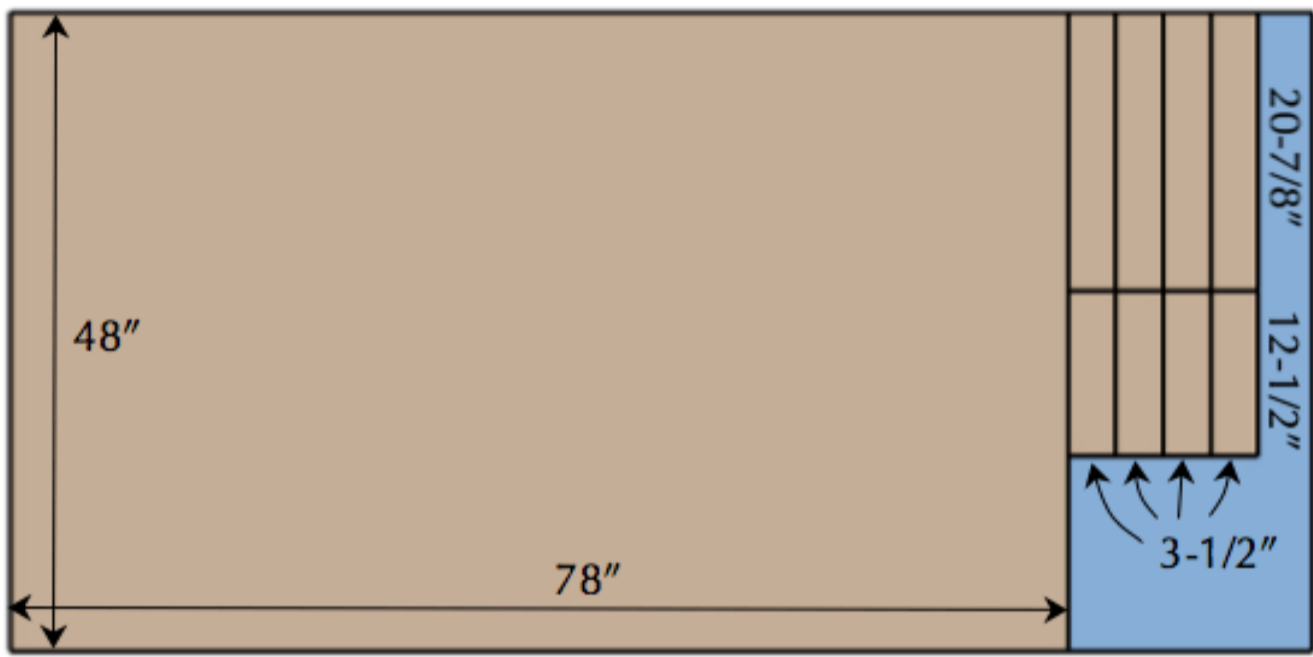

Cut List (2 of 2)

3/4" x 48" x 96" (Qty 2)

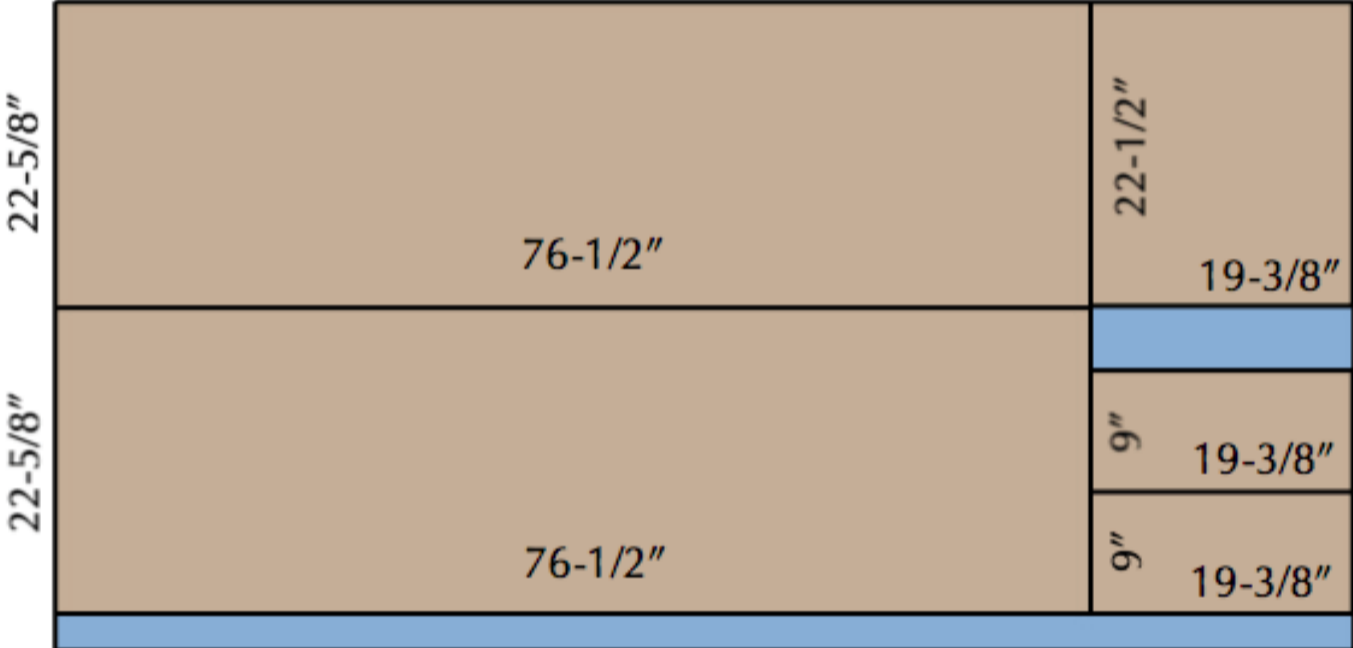
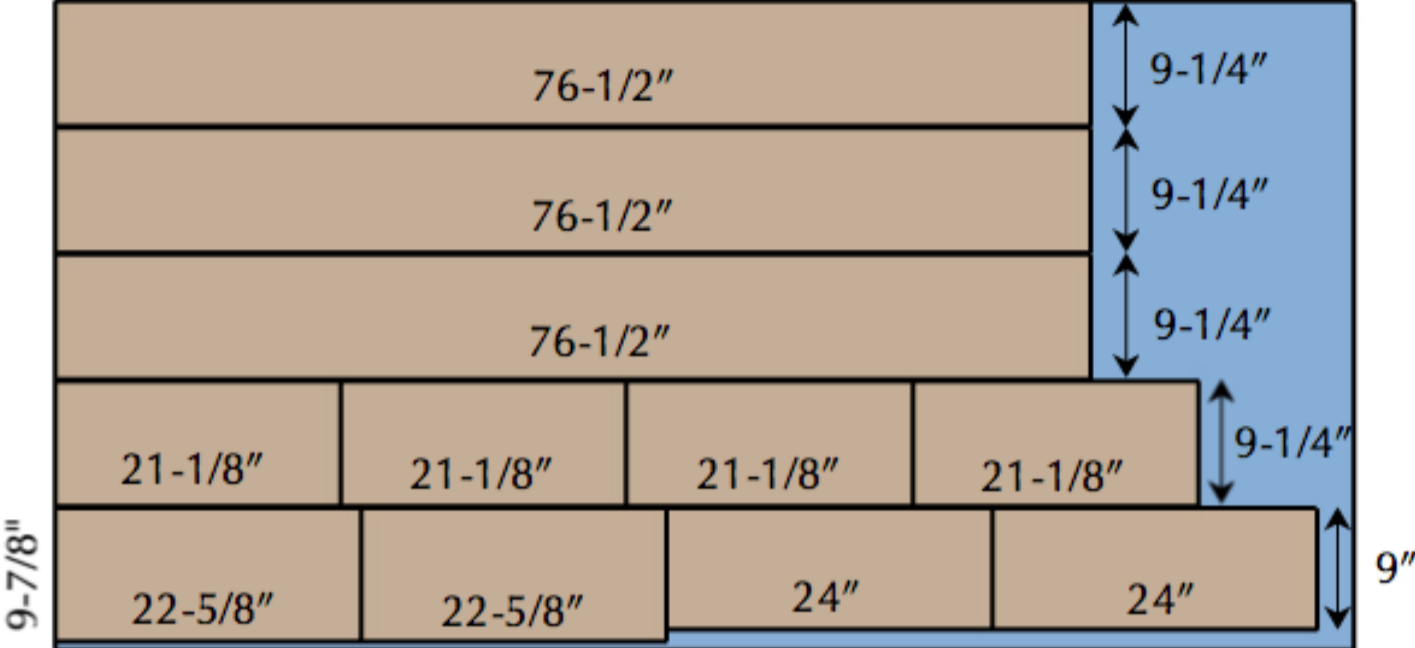

1 x 2 x 6" (Qty 2)

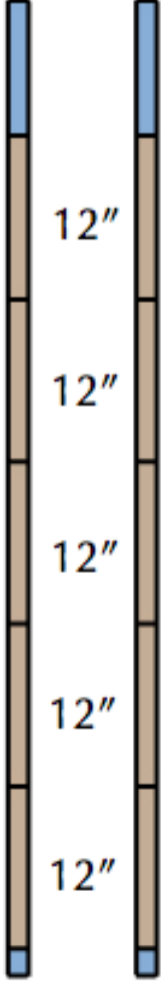

1/4" x 48" x 96"

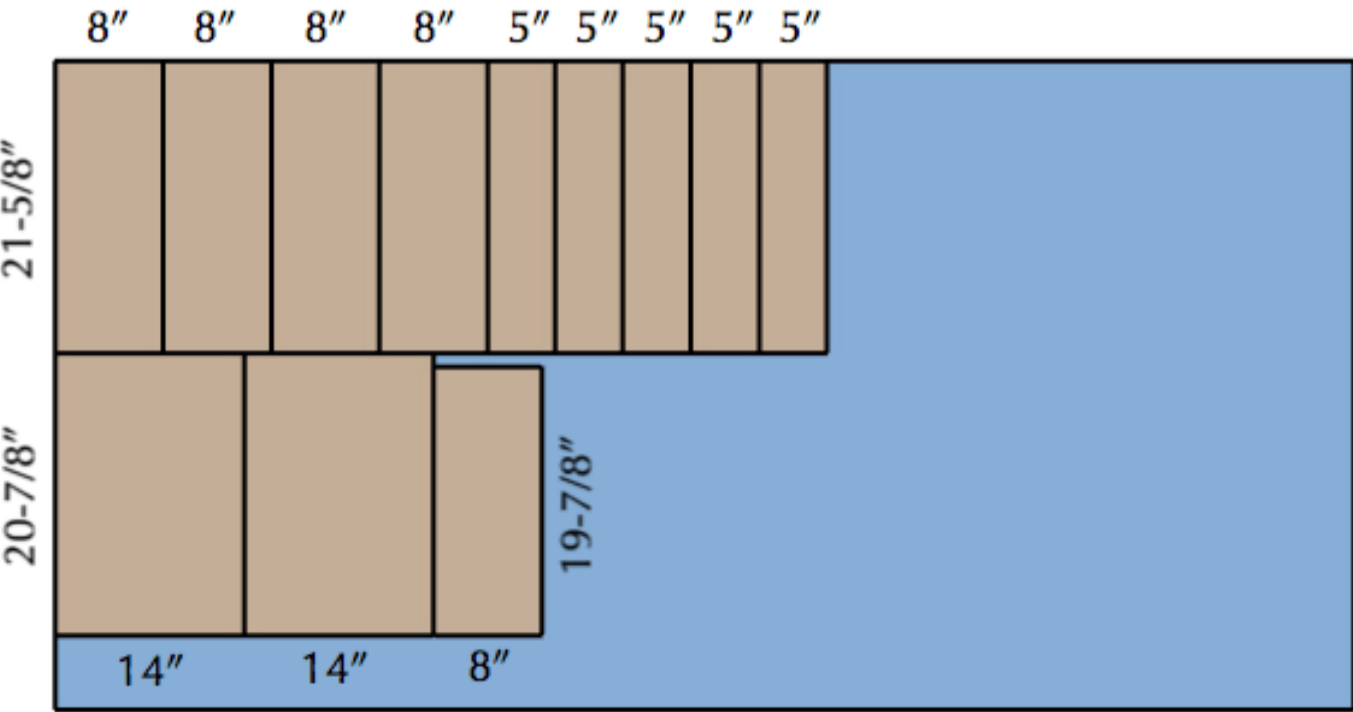

Step 1: Assemble Drawer Box

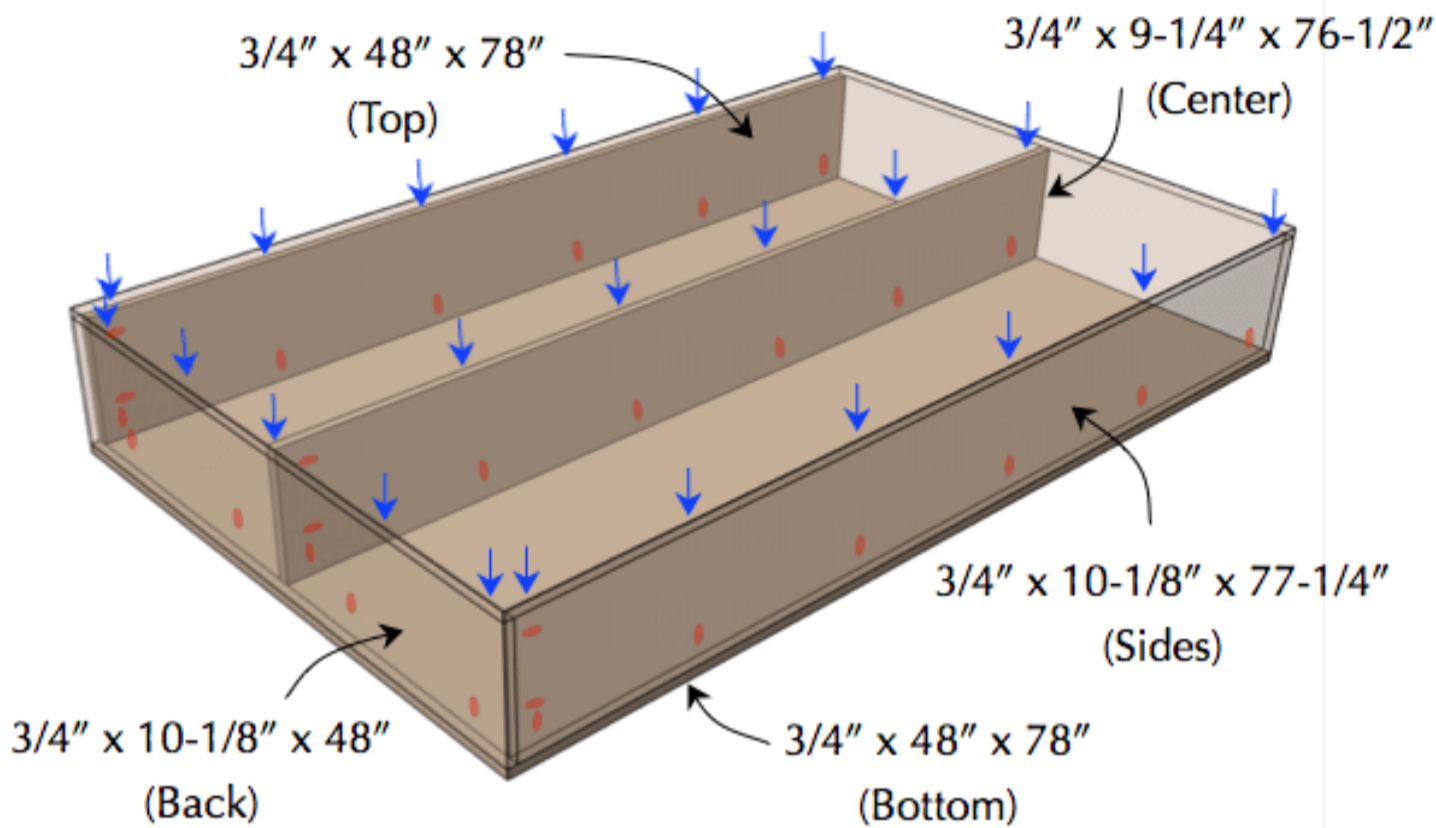

Before assembly, **sand interior side of all panels smooth and polyurethane** as it will be impossible after. Then, **drill pocket holes** and assemble sides, center, back and bottom using **wood glue** and **1-1/4" pocket screws**. Then, pre-drill and attach top with **wood glue** and **1-1/4" wood screws**.

Step 2: Assemble Drawers (Qty 2)

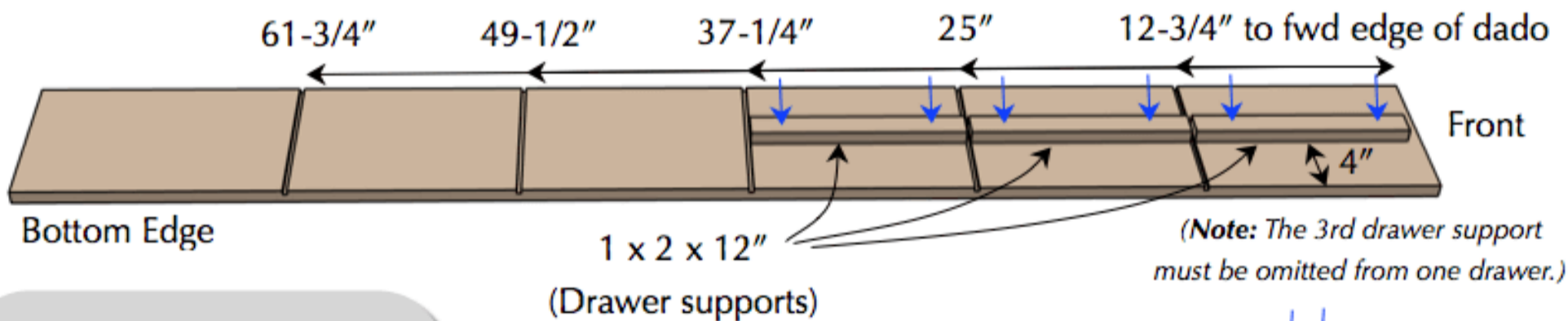

Cut 1/4" wide dados 5/16" deep, in each side panel (Qty 4) as shown. Next, pre-drill and install drawer supports using **wood glue** and **1-1/4" wood screws**. Then, assemble both drawers using **wood glue** and **1-1/4" wood screws**. Fill screw holes with wood filler, sand smooth and polyurethane.

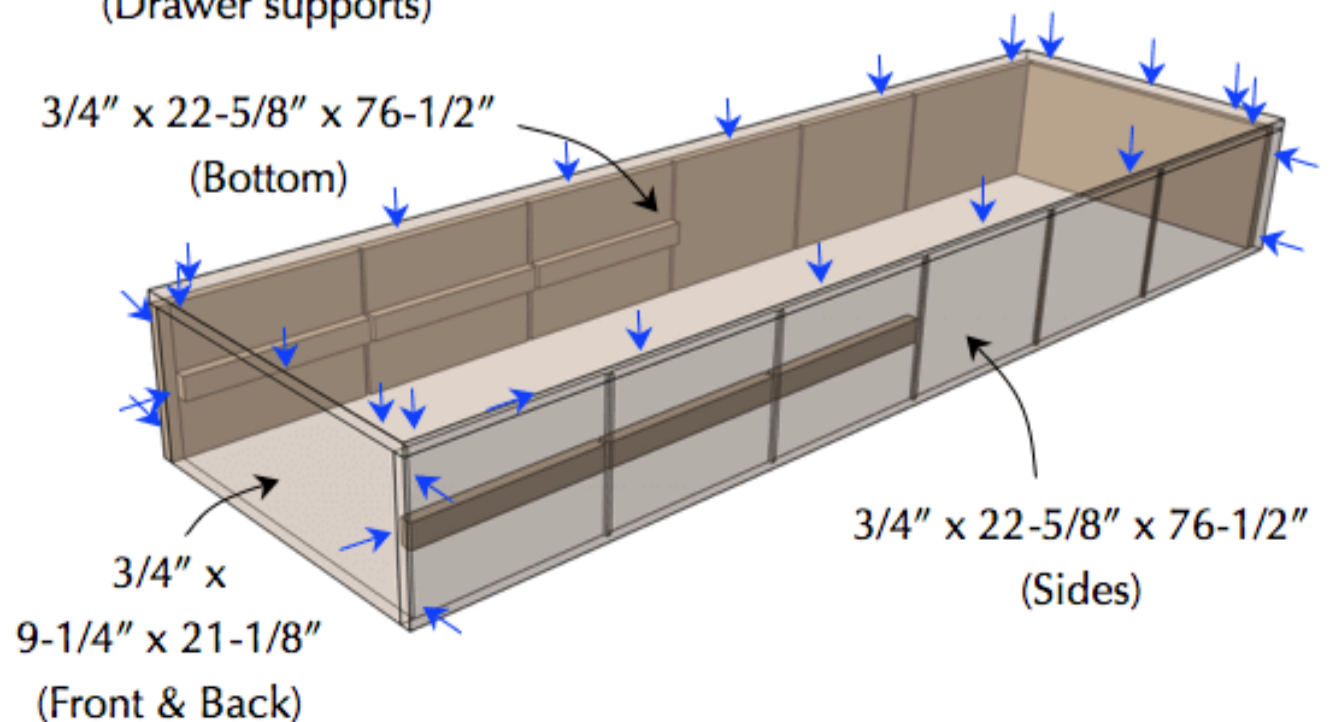

Step 3: Assemble Power Crate

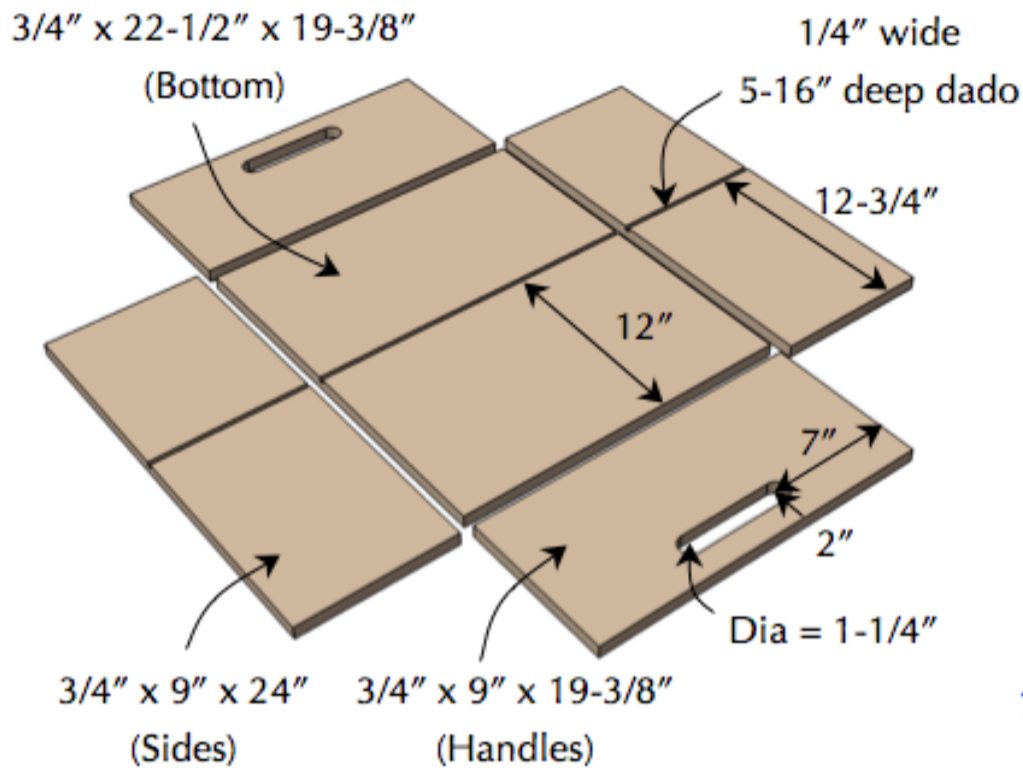

Optional:

Cut 1/4" wide dado, 5/16" deep in the sides and bottom panel as shown. Cut out handles by drilling two 1-1/4" holes and connect using jigsaw. (Note: Divider/dado placed to accept Ryobi supercharger)

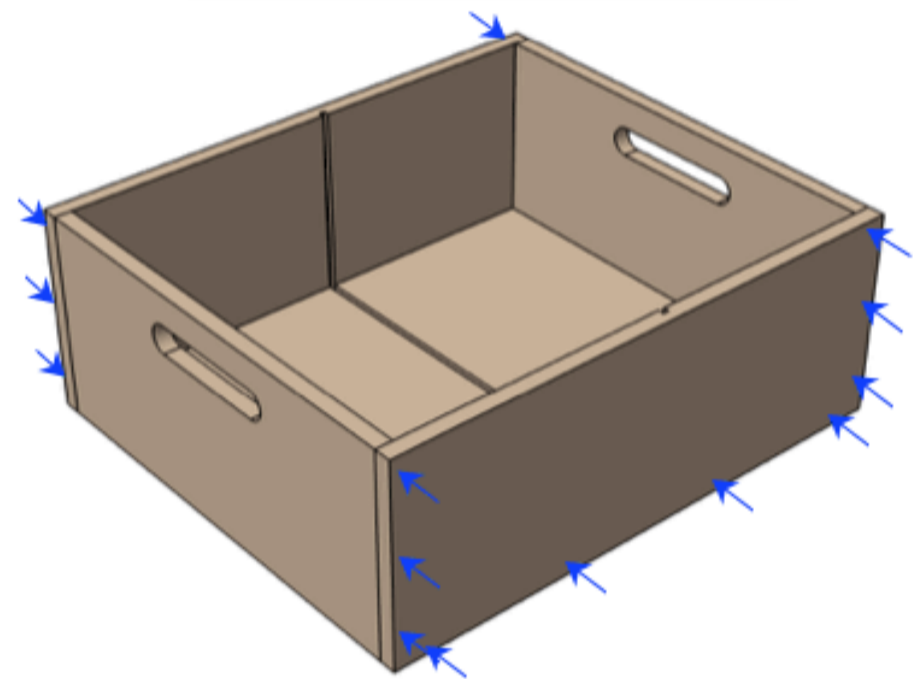

Pre-drill and assemble power crate using **wood glue** and **1-1/4" wood screws**. Fill screw holes with wood filler and sand smooth.

Step 4: Assemble Drawers (Qty 2)

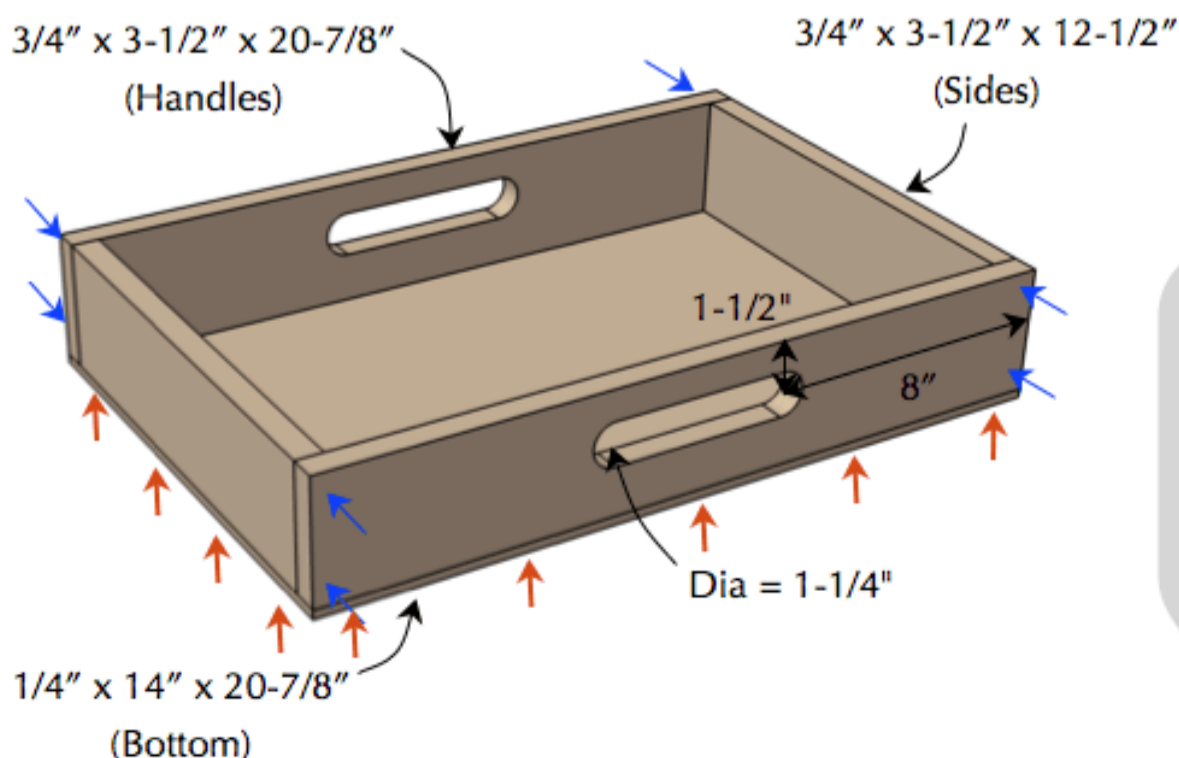

Cut out handles by drilling two 1-1/4" holes and connect using jigsaw. Assemble frame using **wood glue** and **1-1/4" wood screws**. Then, glue and nail bottom on using **1-1/4" brad nails**.

Step 5: Drawer Fronts & Handles

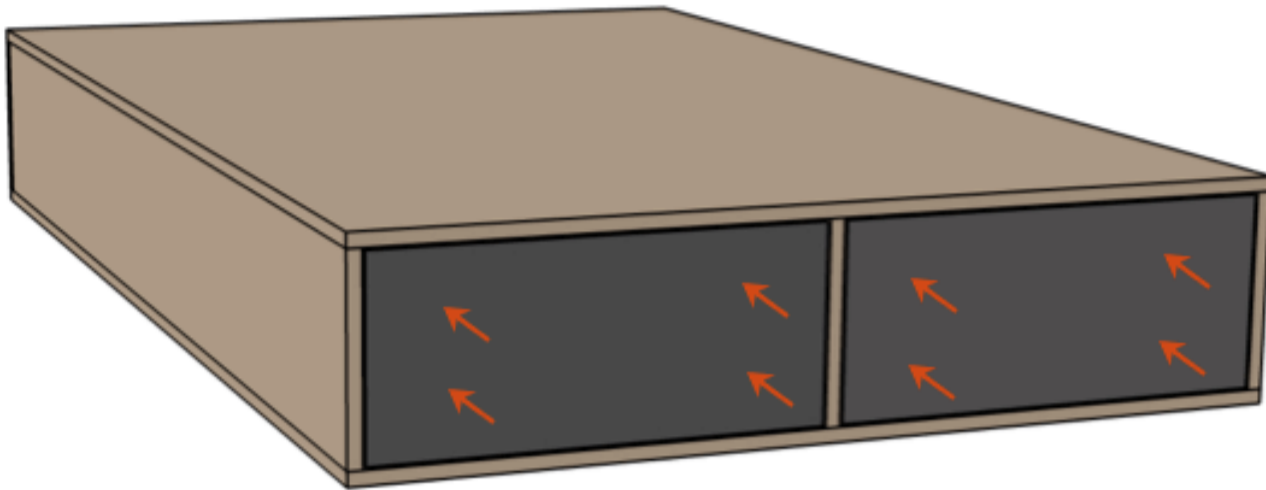

With drawers in place, locate drawer fronts such that there is an even gap on all sides and attach using **wood glue** and **1-1/4" brad nails**.

From the inside of the drawer screw through and into the drawer front using **1-1/4" wood screws**.

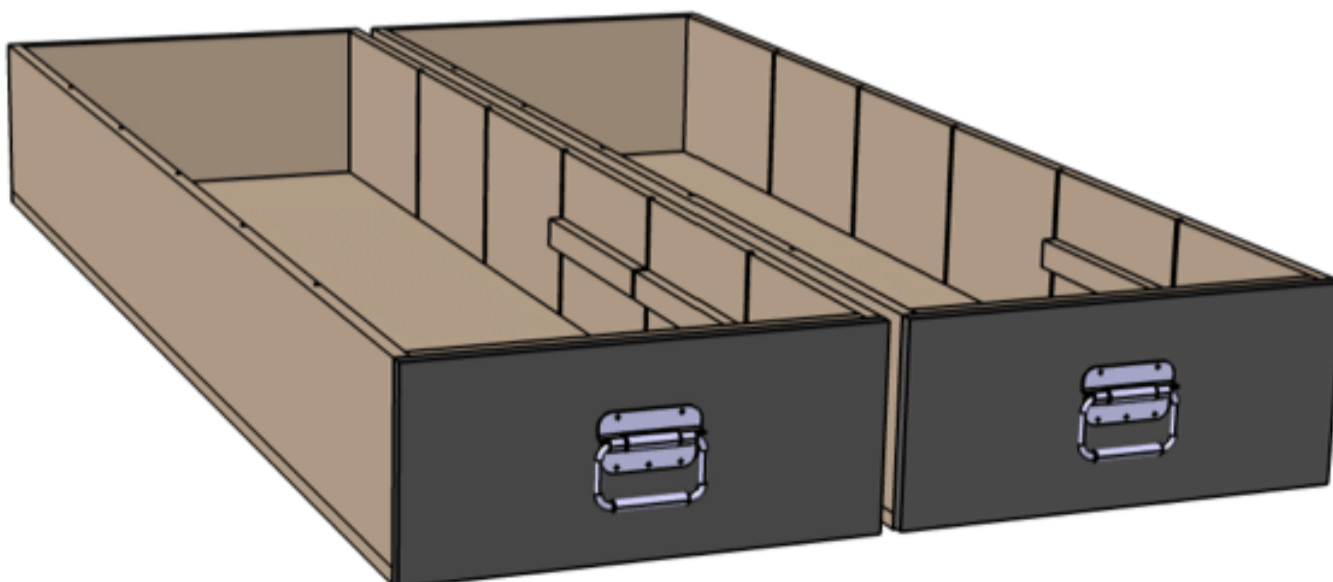
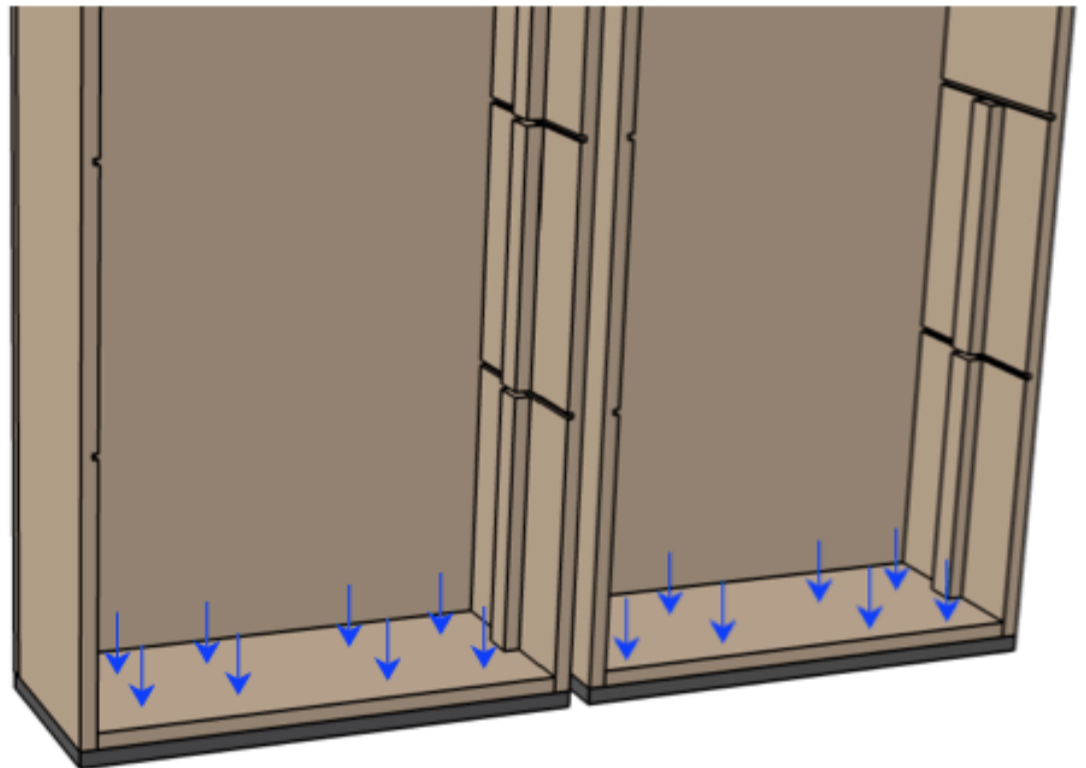

Finish the drawer fronts and install drawer pulls as desired.

Step 6: Finish and Install

Apply a bed liner paint or waterproofing finish to the drawer box.

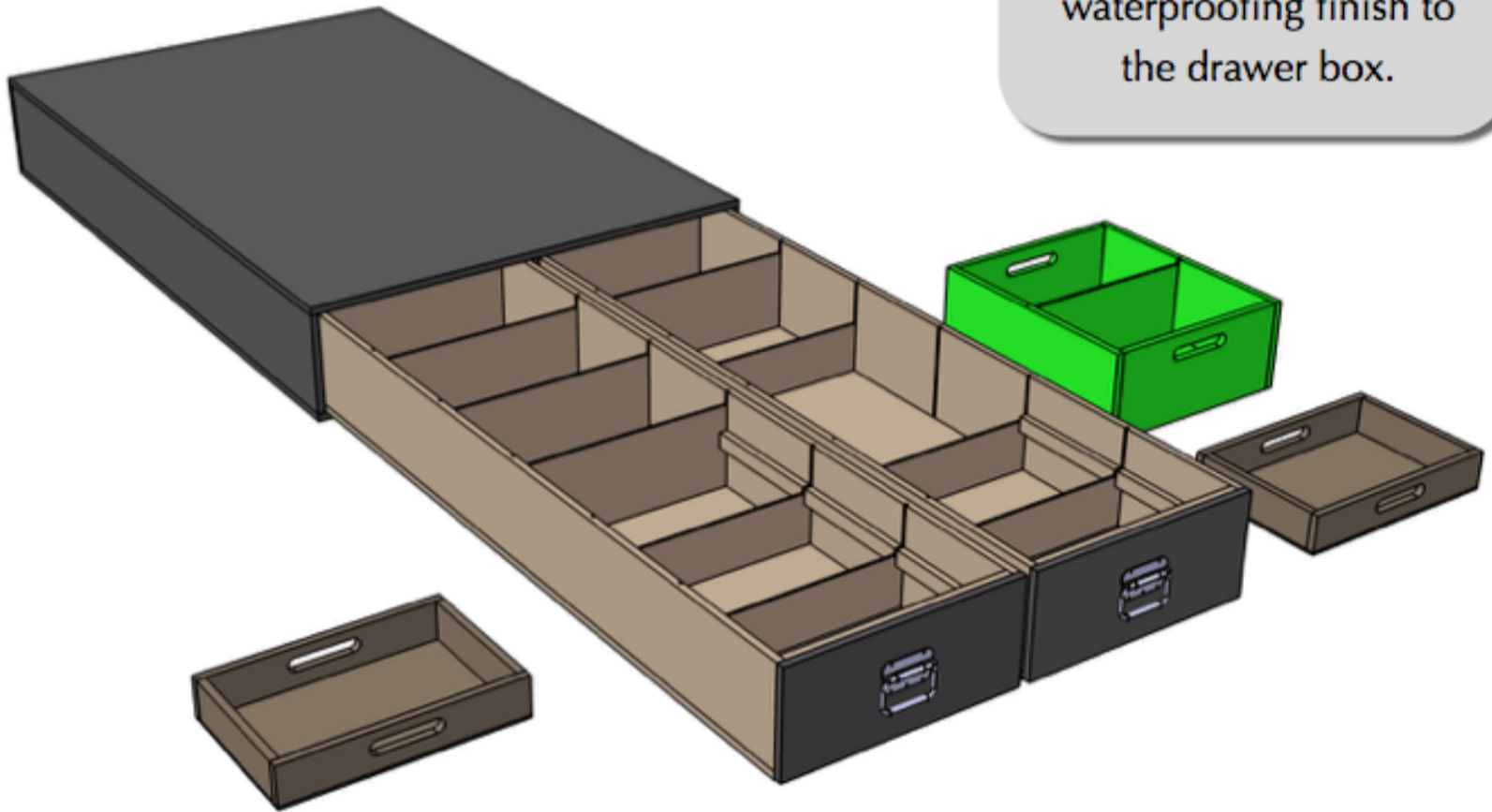

Paint or stain and poly the drawers, power crate and dividers as desired.

Note: A smooth finish will help drawer function.

Insert dividers, crate and drawers. Place in truck bed and tie down using ratcheting straps or equivalent.

